



WCCLRMA

WEBB COUNTY- CITY OF LAREDO REGIONAL MOBILITY AUTHORITY

The Webb County City of Laredo Regional Mobility Authority (WCCL RMA) was formally petitioned jointly by Webb County and the City of Laredo to the Texas Transportation Commission for its formation on April 15, 2013 (City of Laredo) and August 18, 2013 (Webb County). The Texas Transportation Commission approved the creation of the WCCL RMA on February 27, 2014.

The WCCL RMA is unique in Texas as it is the only RMA that was jointly formed by both a City and a County. The WCCL RMA Board of Directors consists of nine (9) members. Four members of the Board of Directors are jointly selected by City Council Districts 1 and 2, Districts 3 and 4, District 5 and 6 and Districts 7 and 8. Four members of the Board of Directors are individually selected by members of Commissioners Court from each of the four precincts. The ninth member is the Chair of the Board of Directors who is directly appointed by the Governor of the State of Texas. Each Director serves as a volunteer and is not compensated for any of his or her time spent in service on the Board of Directors. Furthermore, no Director can have any financial interest that would benefit from the actions of the WCCL RMA. The members of the Board of Directors are the following:

1. Chairman of the Board of Directors – Mr. Ruben Soto
2. County Precinct No. 1 Director – Mr. Jesus D. Romero
3. County Precinct No. 2 Director – Mr. Oscar O. Lopez
4. County Precinct No. 3 Director – Mr. Steve LaMantia
5. County Precinct No. 4 Director – Mr. Albert Muller
6. City District 1&2 Director – Mr. Jose Murillo
7. City District 3&4 Director – Alfonso Mendiola
8. City District 5&6 Director – Douglas B. Howland
9. City District 7&8 Director – Arturo Dominguez

Since its formation, the RMA Board was entrusted to organize the agency which entailed hiring consultants, developing policy, holding meetings and filing regulatory annual and periodic reports, including the annual audit as required by the City and County.

The single revenue source for the RMA is from the \$10 fee per vehicle registered in Webb County which was approved by the 83rd Texas Legislature to fund long-term transportation projects of a regional mobility authority. With these monies, the RMA has been able to perform its role in developing solutions for helping to advance mobility priorities for Webb County and the City of Laredo. It should be noted that the RMA does not have any paid employees or facilities from which to conduct its business; however, it does have startup and operating expenses. TxDOT and other entities have lent us their facilities and resources for RMA Board meetings.

What has the WCCL RMA done to date?

- I. **Initial Project** - Vallecillo Road, from FM 1472 to the IH-35 Southbound Frontage Road (February 2015 to Present). The Laredo MPO Policy Committee requested that the RMA take on this new location roadway in early 2015. Improvements consist of the installation of a 5-lane roadway with curb, sidewalk, lighting and utilities for a total length of 2.75 miles. This new location



WCCLRMA

WEBB COUNTY- CITY OF LAREDO REGIONAL MOBILITY AUTHORITY

corridor will serve as a relief route for traffic on FM 1472 trying to reach IH-35. As part of this project, the RMA is conducting an Environmental Assessment and will continue to investigate possible funding sources for the implementation of this project through local, state, and federal sources as well as the feasibility of a corridor Transportation Reinvestment Zone (TRZ).

Considering the size and location of the TRZ, the RMA is considering expanding the limits of the TRZ to help fund improvements along FM 1472 and Hachar, as well as Vallecillo Road. To date the project does not have identified funding. Currently, the project is tentatively scheduled for completion in 2022.

NET LENGTH OF PROJECT = 14,670 FT = 2.78 MI
NET LENGTH OF ROADWAY = 14,670 FT = 2.78 MI

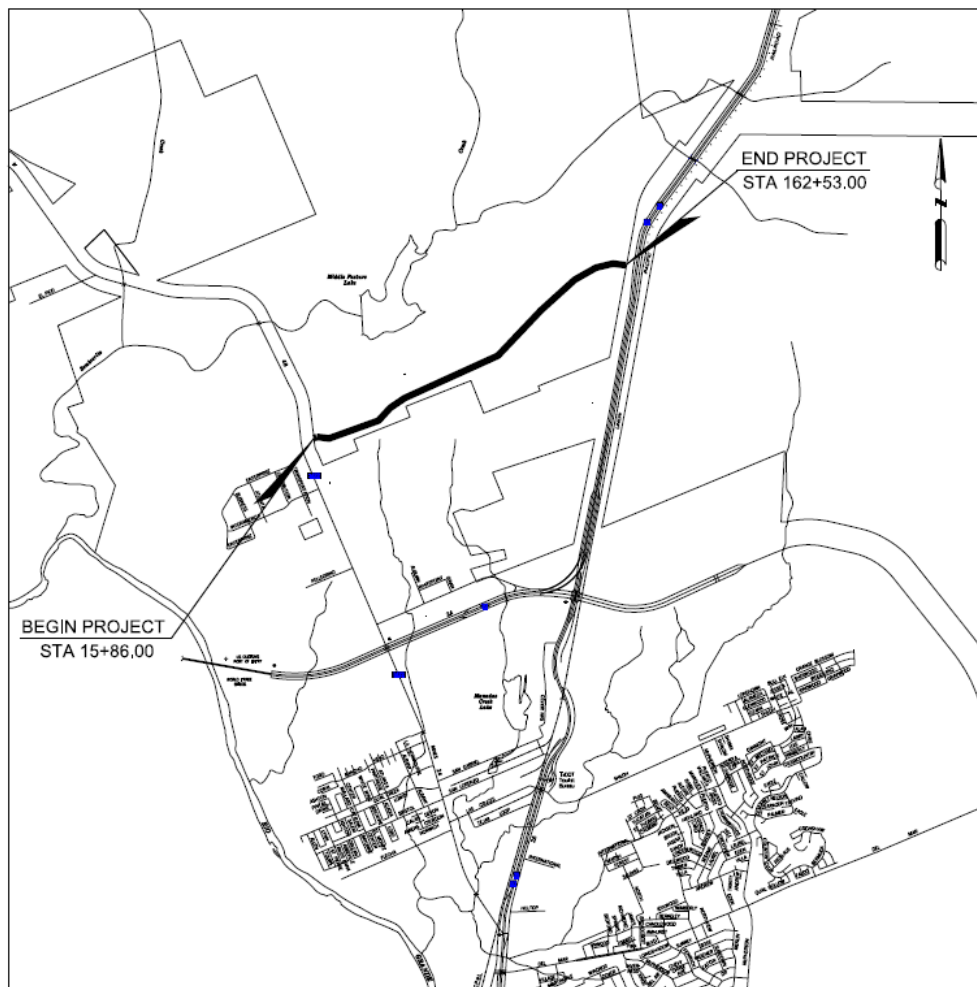

LOCATION MAP
NTS

Figure 1



WCCLRMA

WEBB COUNTY- CITY OF LAREDO REGIONAL MOBILITY AUTHORITY

- II. Loop 20 (Upgrade to Interstate Standards), between the International Boulevard and the US 59/Loop 20 intersection. The Priority Project for the RMA and the main reason for the formation of the RMA, the RMA developed a financial plan to implement the project to interstate standards via Design Build Finance. The financial plan determined that the use of TRZ from IH 35 to US 59 coupled with current funds projected to be dedicated to the Laredo Community from and federal and state sources could advance the project for completion within five years. To that end, the RMA conducted an industry review workshop with prospective design build developers to gauge the level of interest from the developer community. The workshop was well attended with over 60 attendees from the construction, design build and engineering community. The RMA followed-up the industry review workshop with a series of one-on-one meetings with prospective design build developers. The Community is currently utilizing projected funding from the UTP to begin implementing the five proposed overpasses within the project limits (Shiloh, Del Mar, University, Jacaman and Airport).
- III. FASTLANE Grant Application Efforts – In the effort to explore other funding opportunities for the Laredo Community, the RMA invested monies to develop and submit a FASTLANE Grant Application for the development of the overpass at Jacaman Road and Loop 20. A highly competitive grant where communities across the United States of America were competing for a share \$500 Million, the USDOT received over \$9.8 Billion in applications. It should be noted that no community nor the DOT in the State of Texas received a grant award. Subsequently, the RMA has provided support with their GEC and pledged to provide funding support as part of the community local match for the 2nd round of FASTLANE Applications.
- IV. Other Tasks – The RMA Chairman has worked tirelessly to provide support and value to Webb County and the City of Laredo.
 - Hosted 2 Strategic Workshops (March 2016 and October 2017) to have a “meeting of the minds” with the leaders of the community and the TxDOT Laredo District regarding the short term and long term mobility priorities of the community.
 - Facilitated an audience with TxDOT Chief Engineer Bill Hale to meet with the leaders of the City of Laredo and Webb County for a discussion on funding opportunities for mobility improvements in the community.
 - Provided an independent engineering review for the Webb County Espejo Gates project.
 - Provided a funding option for the City of Laredo for completion of the Hachar Schematic, in order for the City to not exceed its programmed budget.

WCCLRMA Plans for 2018

- I. Transportation Reinvestment Zone Studies
 - Upon final concurrence by Laredo MPO Policy Committee, the RMA will move forward with a revenue study for a TRZ in North Webb County from Loop 20 to Camino Columbia along FM 1472. The zone could also extend along the future locations of Hachar and Vallecillo Road from FM 1472 to IH 35.



WCCLRMA

WEBB COUNTY- CITY OF LAREDO REGIONAL MOBILITY AUTHORITY

- The RMA is also considering the updating the revenue study for a TRZ that was commissioned by TxDOT in 2013 along Loop 20 from IH 35 to US 59.
- II. Planning Studies
- North Webb County/ Laredo Transportation Study - Upon final concurrence by the Laredo MPO Policy Committee, the RMA is prepared to conduct a long term transportation study for mobility improvements in North Webb County from Loop 20 to Camino Columbia along FM 1472. This will be the first phase for getting FM 1472 shovel ready for future funding from state and federal sources.
 - Outer Loop - - Upon final concurrence by the Laredo MPO Policy Committee, the RMA is prepared to update the original planning study conducted by TxDOT in the late 2000s and develop a project implementation plan with environmental constraints analysis for the development of the Outer Loop. This will be the first phase for getting the Outer Loop shovel ready for future funding from state and federal sources.
- III. International Bridge 4-5
- The RMA has been communicating City and County leadership and a possible developer for the full implementation of a new Port of Entry in Southern Webb County. One of the extensive abilities of the RMA is to work across County, State and International jurisdictions on behalf of its sponsored communities. The RMA is the ideal vehicle to serve as the main sponsor the project Presidential Permit that will be required for the project to be implemented. The project is still in the early planning stages.
- IV. Other Projects in 2018 and beyond
- Expansion of FM 1472 (Mines Road)
 - Construction of the Outer Loop, from US 83 in southern Webb County to Camino Colombia north of Laredo with priority emphasis on the segment from Hwy 59 to Hwy 359.
 - Construction of Vallecillo Overpass at IH-35 and inner loop from IH-35 to US 83
 - Expanding the southern portion of Loop 20, currently Cuatro Vientos
 - Building a direct connection of Loop 20 to US 83
 - Construction of an East Rail Bypass
 - Vallecillo Road Intermediate Loop from IH 35 to US 59
 - I69 Upgrade (US 59 to Nueces County Line)

In summary, the RMA has historically been utilized by communities in different ways. Due to the vast powers of the RMA, it has been used as a vehicle for the development of toll roads, to pool the tax bases of multiple pre-dominantly low moderate income Counties to apply for a State Infrastructure Bank Loan, to develop multi-modal solutions for communities, etc. Here in Laredo, the RMA can utilize its funding sources to perform studies to help develop new funding sources for transportation, work to develop projects and make them shovel ready for future funding from the state and federal sources, can act as bridge in project delivery between the County, the City, TxDOT, Mexico, etc. How it is utilized is as the behest of the leaders of our community.



WCCLRMA

WEBB COUNTY- CITY OF LAREDO
REGIONAL MOBILITY AUTHORITY

Ruben Soto Jr

Ruben Soto, Jr., CPA
Presiding Officer
Webb County – City of Laredo Regional Mobility Authority